

Current part is item (6,4) on diagram. Available at www.oshkoshequipment.com

(1) FIG. NO.	(2) ITEM NO.	(3) SMR CODE	(3) NATIONAL STOCK NUMBER	(4) PART NUMBER	(5) FSCM	(6) DESCRIPTION USABLE ON CODE	(7) U/M	(8) INC IN UNIT
1004-STEERING MECHANISM								
107	3	PAOZZ	4730-00-050-4208	MS15003-1	96906	FITTING,LUBRICATION:UPPER AND LOWER SHEAVE	EA	2
107	26	PAOZZ	5340-00-707-1100	7071100	19207	CLAMP,LOOP:INNER,STEERING KNUCKLE FLANGE BOOT	EA	2
107	27	PAOZZ	5310-00-707-1097	7071097	19207	NUT,PLAIN,HEXAGON:STEERING KNUCKLE FLANGE CLAMP	EA	1
107	28	PAOZZ	5305-00-752-1693	7521693	19207	SCREW,MACHINE: STEERING KNUCKLE FLANGE CLAMP	EA	1
107	29	XAOZZ		7071085	19207	CLAMP	EA	1
107	30	PAOZZ	5340-00-707-1099	7071099	19207	CLAMP,LOOP: OUTER,STEERING KNUCKLE FLANGE BOOT	EA	2
107	31	PAOZZ	5310-00-707-1097	7071097	19207	NUT,PLAIN,HEXAGON: STEERING KNUCKLE FLANGE CLAMP	EA	1
107	32	PAOZZ	5305-00-752-1693	7521693	19207	SCREW,MACHINE: STEERING KNUCKLE FLANGE,CLAMP	EA	1
107	33	XAOZZ		7071084	19207	CLAMP	EA	1
107	34	PAOZZ	2530-00-741-0883	7410883	19207	BOOT,STEERING KNUCKLE: FLANGE	EA	2
107	35	PAOZZ	4820-00-726-4719	5196397	00000	VALVE,RELIEF	EA	1
108	1	PAOZZ	5306-00-182-9267	10896726	19207	BOLT, MACHINE	EA	16
108	2	PAOZZ	5310-00-584-5272	MS35338-48	96906	WASHER,LOCK	EA	16
108	3	PAOZZ	2520-00-752-1861	7521861	19207	FLANGE,AXLE SHAFT: DRIVE W/PLUG	EA	2
108	4	PAOZZ	5340-00-752-1762	7521762	19207	PLUG, EXPANSION	EA	1
108	5	XAOZZ		8757694	19207	FLANGE	EA	1
108	6	PAOZZ	5330-00-599-4230	7521787	19207	GASKET: DRIVE FLANGE	EA	2
108	7	PAOZZ	5310-00-220-2665	10896720	19207	NUT,PLAIN,OCTAGON:ADJUSTING BEARING	EA	4
108	8	PAOZZ	5310-00-752-1650	10896695	19207	WASHER,KEY:BEARING ADJUSTING NUT	EA	2
108	9	PAOZZ	3110-00-087-9881	10948079	19207	BEARING ASSEMBLY: HUB,OUTER	EA	2
108	10	PBOFF	2530-00-193-8187	7529053	19207	HUB AND DRUM ASSEMBLY: LEFT (COMPONENTS SAME AS HUB AND DRUM ASSEMBLY, NSN 2530-00-193-8183, EXCEPT WHERE INDIVIDUAL COMPONENTS ARE ANNOTATED) (TO BE REPAIRED USING COMPONENTS ONLY)	EA	1
108	10	PBOZZ	2530-00-193-8183	7529054	19207	HUB AND DRUM ASSEMBLY: RIGHT (TO BE REPAIRED USING COMPONENTS ONLY)	EA	1
108	11	PAOZZ	5310-00-732-0559	MS51968-8	96906	NUT,SELF-LOCKING	EA	1
108	12	PAOZZ	5310-00-637-9541	MS35338-46	96906	WASHER,LOCK	EA	10
108	13	PAOZZ	2530-00-134-5121	10896733	19207	COVER, INSPECTION	EA	1

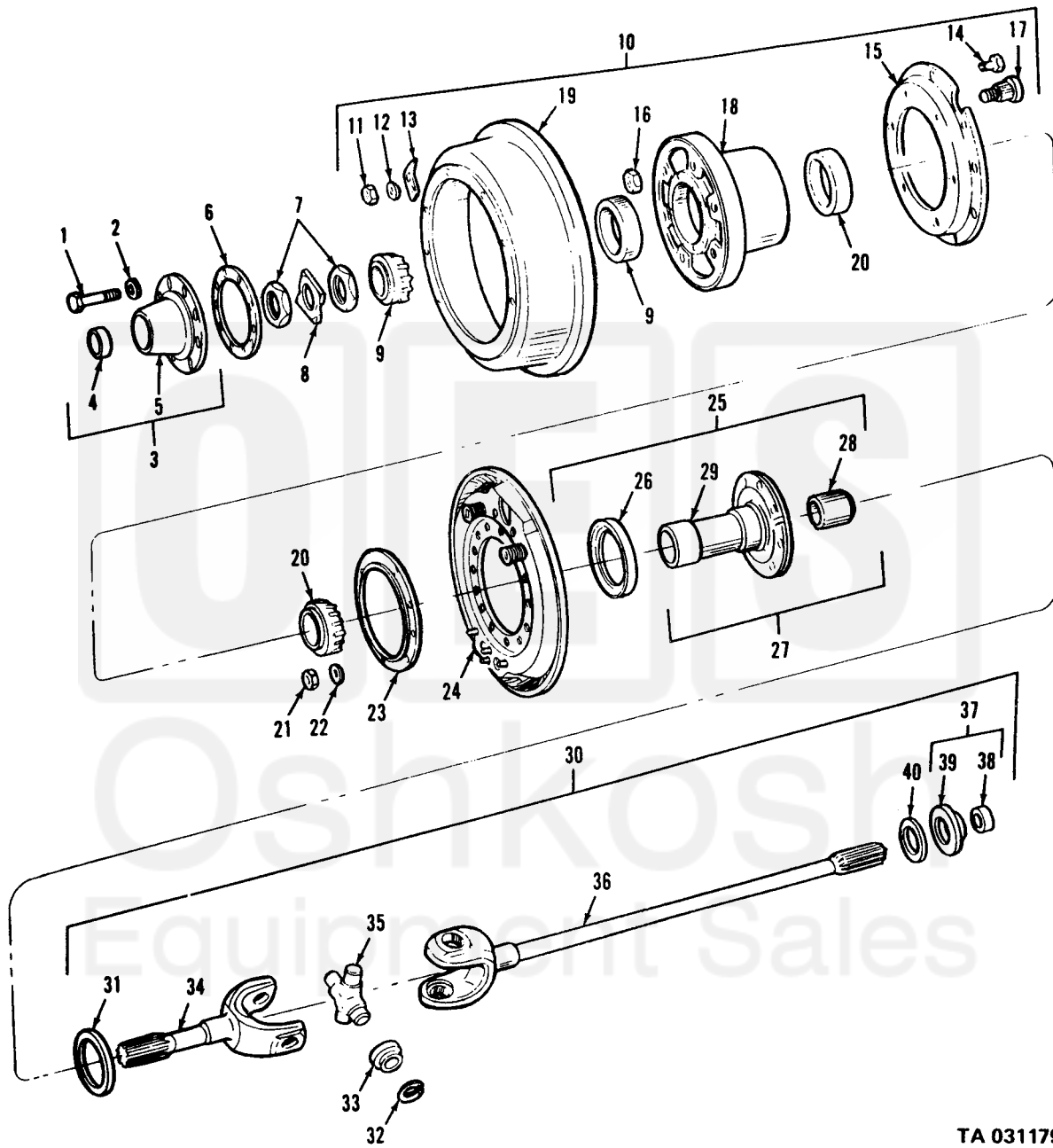

Current part is item (6,4) on diagram. Available at www.oshkoshequipment.com



TA 031179

Figure 108. Front axle shafts, hubs and drums.

(1) FIG. NO.	(2) ITEM NO.	(3) SMR CODE	(3) NATIONAL STOCK NUMBER	(4) PART NUMBER	(5) FSCM	(6) DESCRIPTION USABLE ON CODE	(7) U/M	(8) INC IN UNIT
GROUP 11 - REAR AXLE								
1100 - REAR AXLE ASSEMBLY								
109	12	PAOZZ	5365-00-732-6126	7326126	19207	PLUG,MACHINE THREAD: FILLER	EA	1
109	13	PAOZZ	5330-00-514-3289	MS35769-21	96906	GASKET: FILLER PLUG	EA	1
109	14	PAOZZ	4730-00-240-9320	10896735	19207	PLUG,PIPE,MAGNETIC: DRAIN	EA	1
110	1	PAOZZ	5306-00-182-9267	10896726	19207	BOLT,MACHINE: BRAKE DRAIN ADAPTER	EA	32
110	2	PAOZZ	5310-00-584-5272	MS35338-48	96906	WASHER,LOCK: BRAKE DRAIN ADAPTER	EA	32
110	3	PAOZZ	2520-00-752-1730	7521730	19207	SHAFT,AXLE,AUTOMOTIVE: REAR	EA	2
110	4	PAOZZ	5330-00-599-4230	7521787	19207	GASKET: SHAFT	EA	4
110	5	PAOZZ	5310-00-220-2665	10896720	19207	NUT,PLAIN,OCTAGON:ADJUSTING BEARING	EA	8
110	6	PAOZZ	5310-00-752-1650	10896695	19207	WASHER,KEY: BEARING ADJUSTING NUT	EA	4
110	7	PAOZZ	5330-00-348-8365	8759693	19207	CORK: WHEEL BEARING LOCK KEYWAY	EA	4
110	8	PAOZZ	5330-00-706-1238	7061238	19207	SEAL,PLAIN,ENCASED: HUB BEARING, OUTER	EA	4
110	9	PAOZZ	3110-00-087-9881	10948079	19207	BEARING ASSEMBLY: HUB,OUTER	EA	4
110	10	PAOOO	2530-00-134-5110	8757681	19207	HUB AND DRUM ASSEMBLY: LEFT (COM- PONENTS SAME AS HUB AND DRUM ASSEMBLY, NSN 2530-00-134-5122, EXCEPT WHERE INDIVIDUAL COMPONENTS ARE ANNOTATED)	EA	2
110	10	PAOOO	2530-00-134-5122	8757682	19207	HUB AND DRUM ASSEMBLY: RIGHT	EA	2
110	11	PAOZZ	5310-00-732-0559	MS51968-8	96906	NUT,SELF-LOCKING	EA	10
110	12	PAOZZ	5310-00-637-9541	MS35338-46	96906	WASHER,LOCK	EA	10
110	13	PAOZZ	2530-00-134-5121	10896733	19207	COVER,INSPECTION: SERVICE BRAKE DRUM	EA	1
110	14	PAOZZ	5306-00-177-5278	10896689	19207	BOLT,RUBBED SHOULDER: SERVICE BRAKE	EA	10
110	15	PAOZZ	2530-00-134-5109	10896706	19207	DEFLECTOR,DIRT AND LIQUID: BRAKE DRUM ADAPTER	EA	1
110	16	PAOZZ	5306-00-930-5248	10896726-1	19207	BOLT,MACHINE: BRAKE DRUM ADAPTER	EA	8
110	17	PAOZZ	5310-00-584-5272	MS35338-48	96906	WASHER,LOCK: BRAKE DRUM ADAPTER	EA	8
110	18	PAOZZ	2530-00-406-1466	8357992	19207	ADAPTER ASSEMBLY	EA	1
110	19	PAOZZ	5310-00-880-2004	MS51983-3	96906	NUT,SINGLE BALL SEAT,HEXAGON: LEFT,WHEEL STUD, OUTER (USED ON HUB AND DRUM ASSEMBLY, NSN 2530-00-134-5110, ONLY)	EA	6

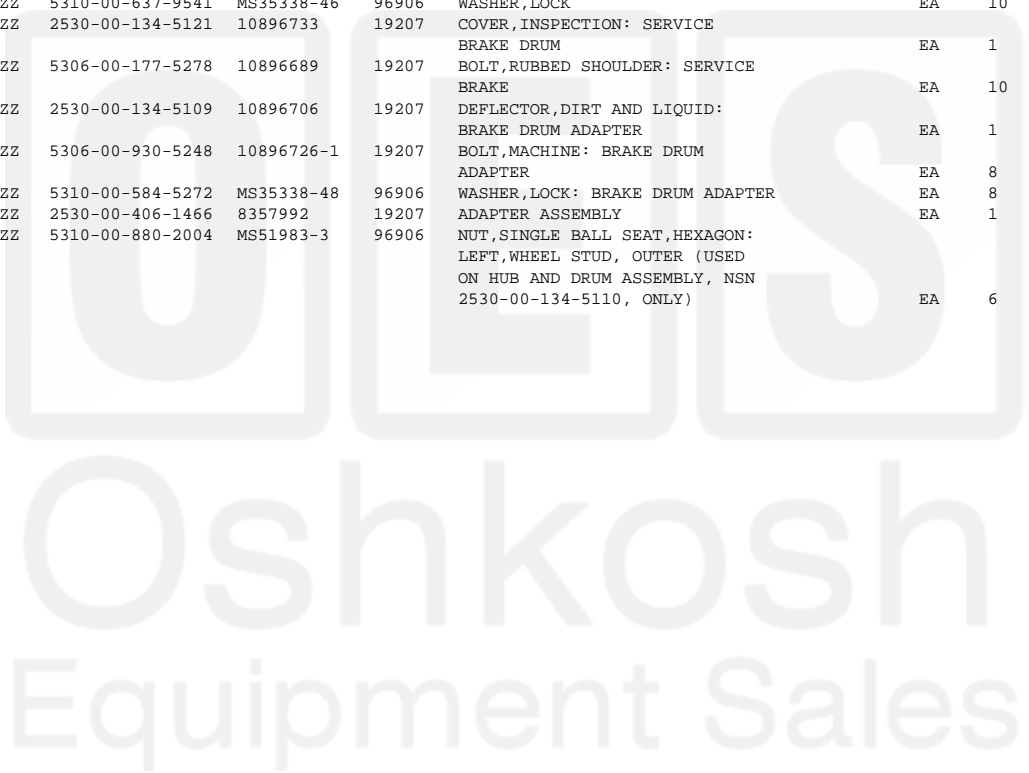

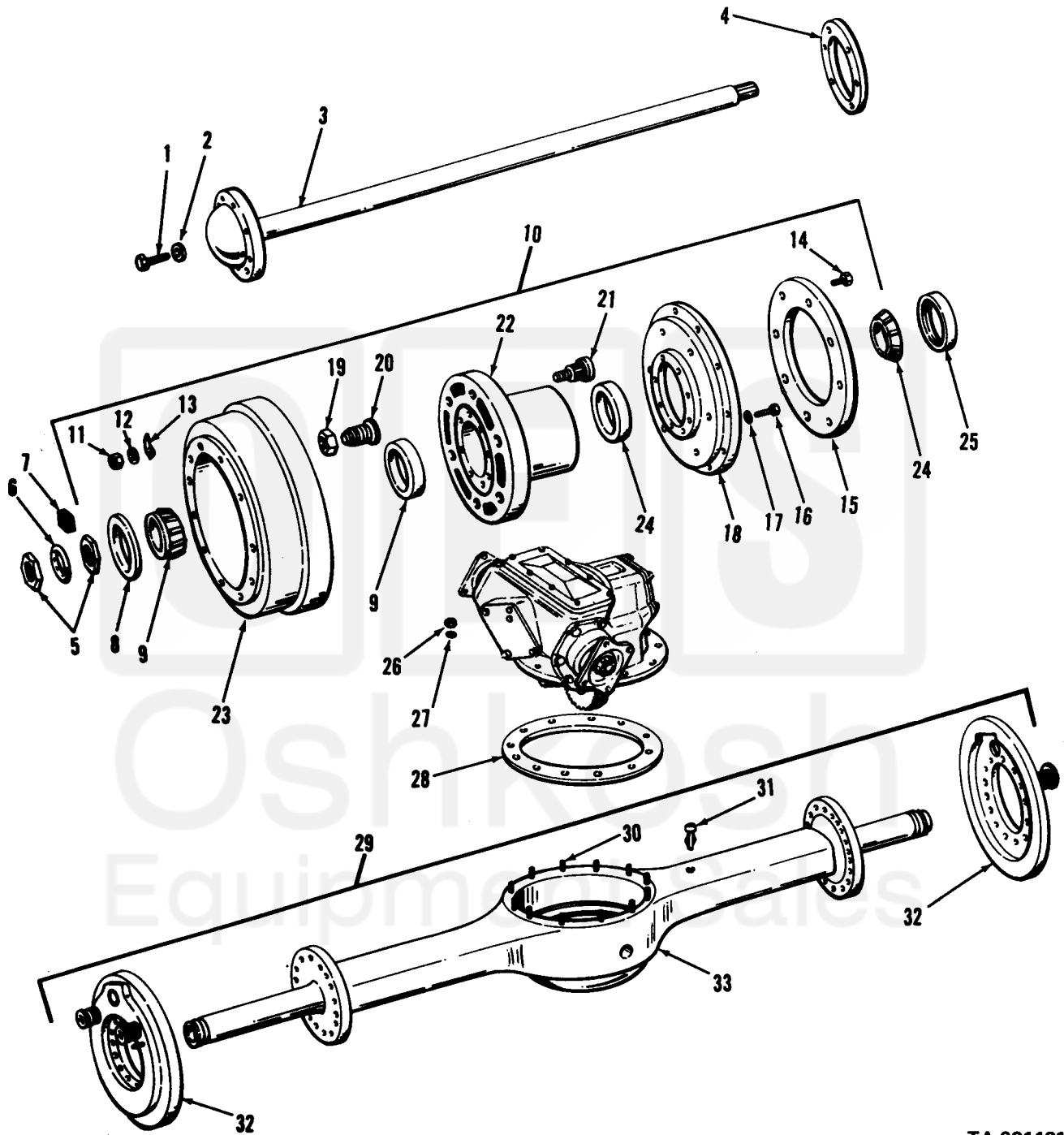

TA 031181

Figure 110. Rear hub, drum and axle shafts.